



KAS PRE-CLEANER

CASEIH 9120, 7230/8230/9230, 7240/8240

ADAPTOR KIT - HIGH MOUNT

INSTALLATION MANUAL

PRODUCT NUMBER: KAS-202

REDEKOP™

KA004-02_R1

This kit is for OEM high mount air cleaner with this configuration:

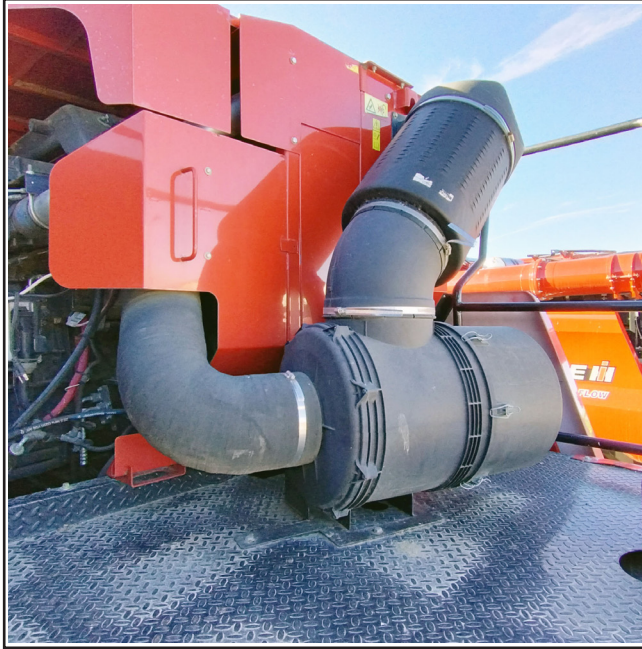

Installed high mount KAS adaptor and KAS Pre-cleaner kit:

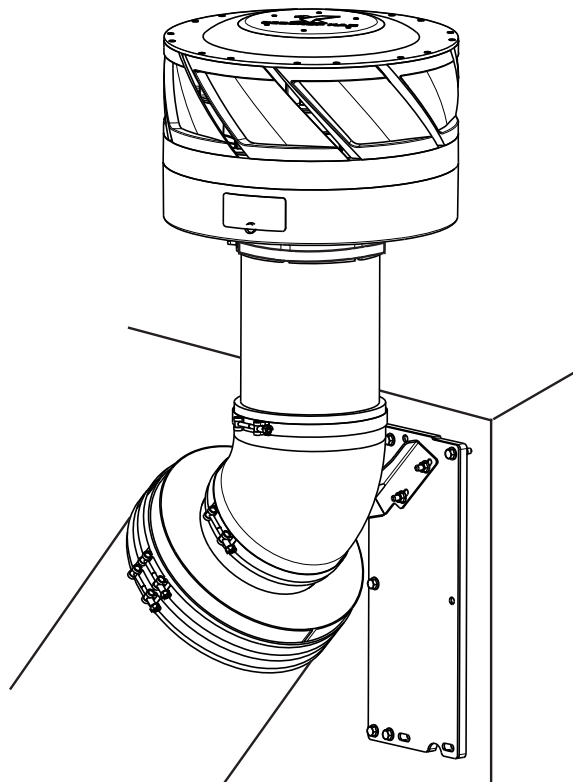

0 Safety

0.1 Instructions

0.1.1 IMPORTANT: Read through this instruction manual thoroughly and familiarize yourself with the KAS Pre-cleaner before installation of these components.

This instruction manual explains the proper procedure for installation of the KAS Pre-cleaner. Do not skip steps or perform them out of order.



0.2 Recognize Safety Information

0.2.1 This is a safety-alert symbol. When you see this symbol on your straw chopper or in this manual, be alert to the potential for personal injury.

Follow recommended precautions and safe operating practices.



0.3 Understand Signal Words

0.3.1 A signal word - DANGER, WARNING, or CAUTION - is used with the safety-alert symbol. DANGER identifies the most serious hazards.

WARNING or CAUTION safety signs are located near specific hazards or precautionary areas in this manual.



0.4 Work In Ventilated Area

0.4.1 Engine exhaust fumes can cause sickness or death. If it is necessary to run an engine in an enclosed area, remove the exhaust fumes from the area with an exhaust pipe extension.

If you do not have an exhaust pipe extension, open the doors and get outside air into the area.



0.5 Remove Key from Ignition

0.5.1 ALWAYS shut off machine engine prior to working on it.

Apply park brake, remove key and lock operators cab.

If the machine is equipped with an additional safety master power switch, turn this to the Power OFF position.

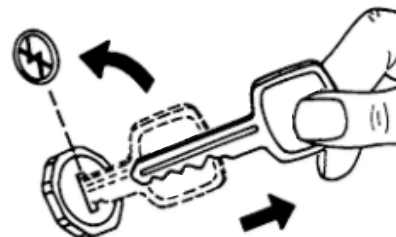

0.6 Block Wheels

0.6.1 Park the machine on level ground.

Always engage the park brake and block the wheels prior to working to prevent the machine from moving.



0.7 Practice Safe Maintenance

0.7.1 Understand service procedure before doing work. Keep area clean and dry.

Never lubricate, service, or adjust machine while it is moving. Keep hands, feet and clothing away from power-driven parts. Disengage all power and operate controls to relieve pressure. Lower equipment to the ground. Stop the engine. Remove the key. Allow machine to cool.

Securely support any machine elements that must be raised for service work.

Keep all parts in good condition and properly installed. Fix damage immediately. Replace worn or broken parts. Remove any buildup of grease, oil or debris.



0.8 Guards and Shields

0.8.1 Keep guards and shields in place at all times. Ensure that they are serviceable and maintained correctly.



0.9 Avoid Contact With Moving Parts

0.9.1 Keep hands, feet and clothing away from power driven parts. Never clean, lubricate or adjust machine when it is running.



0.10 Dispose of Waste Properly

0.10.1 Improperly disposing of waste can threaten the environment and ecology. Potentially harmful waste includes such items as oil, fuel, coolant, brake fluid, filters and batteries.

Use leakproof containers when draining fluids. Do not use food or beverage containers that may mislead someone into drinking from them.

Do not pour waste onto the ground, down a drain or into any water source.

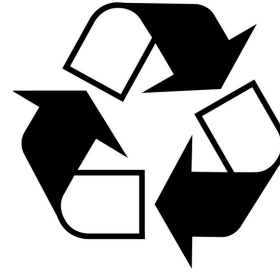

0.11 Personal Protective Equipment (PPE)

0.11.1 A Qualified Person designated by the employer, who is knowledgeable about and familiar with all relevant specifications and assembly instructions and is capable of identifying existing or potential hazards in surroundings or working conditions which may be hazardous or dangerous to employees shall determine appropriate Personal Protective Equipment required for this assembly.

Personal Protective Equipment (PPE) are devices worn by the employees to protect against hazards in the environment. Examples include safety glasses, face shields, respirators, gloves, hard hats, steel-toe shoes, and hearing protection. Wear close fitting clothing and safety equipment appropriate for the job.

Operating equipment safely requires the full attention of the operator. Do not wear radio or music headphones while operating machine.

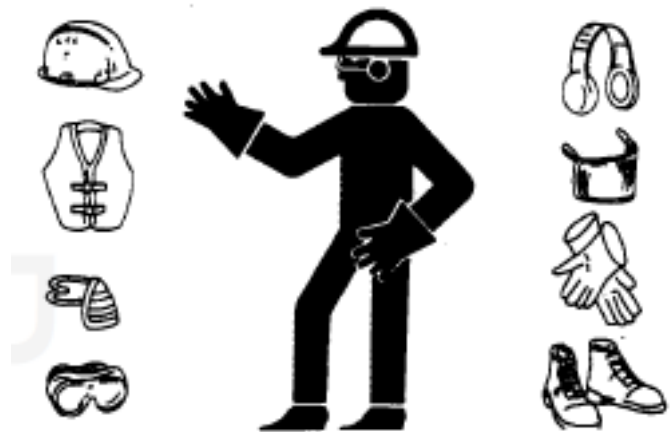

0.12 Prepare for Emergencies

0.12.1 Be prepared if a fire starts.

Keep a first aid kit and fire extinguisher handy.

Keep emergency numbers for doctors, ambulance service, hospital and fire department near your telephone.

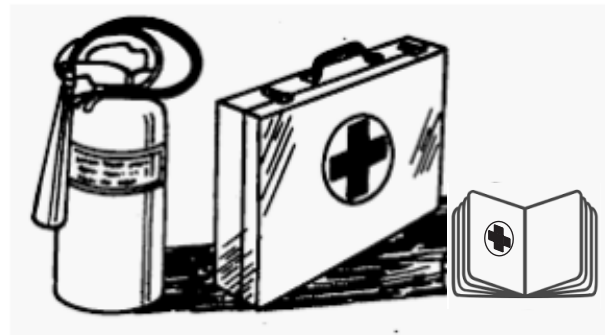

0.13 In the Event of Fire

0.13.1 Stop work immediately at first sign of fire. This may be the smell of smoke or the sight of smoke or flames.



CAUTION: Do not risk personal injury. If a fire is too far advanced, do not try to extinguish it.



If a fire can be safely extinguished, proceed carefully and follow these guidelines:

1. Remove fire extinguisher from bracket and carry it to the area of fire.
2. Approach area of fire wind to your back.
3. Pull the safety pin out of actuating lever.
4. Hold extinguisher upright and aim hose at base of flames.
5. Squeeze lever to discharge fire extinguisher.
6. Move hose to cover the source of the fire evenly with extinguishing agent.

0.14 Safety Decals

Pictorial Safety Signs

At several important places on this machine, safety signs are affixed intending to signify potential danger. The hazard is identified by a pictorial in a warning triangle. An adjacent pictorial provides information on how to avoid personal injury. These safety signs and a brief explanatory text follow.

Hand Injury / Rotate Danger RP1089

Risk of injury caused by rotating parts.



Caution / Check Service Manual RP873

This operator's manual contains all important information necessary for safe machine operation. Carefully observe all safety rules to avoid accidents.



1 KAS Pre-Cleaner Adaptor Kit Installation

Parts List:

KA107BA	Adaptor assembly (A)	Qty 1
KA110B	Air Intake Tube - 15" (B)	Qty 1
KA116B	Adaptor Mount Plate (C)	Qty 1
RP1560	Elbow 45 Deg EPDM - 8" ID (G)	Qty 1
RP1564	Clamp T-Bolt 0.25 x 8.88 ID SS (H)	Qty 2
RP1565	Clamp T-Bolt 0.25 x 13.5 ID SS (J)	Qty 2
KA131A	Rubber Seal (L)	Qty 1

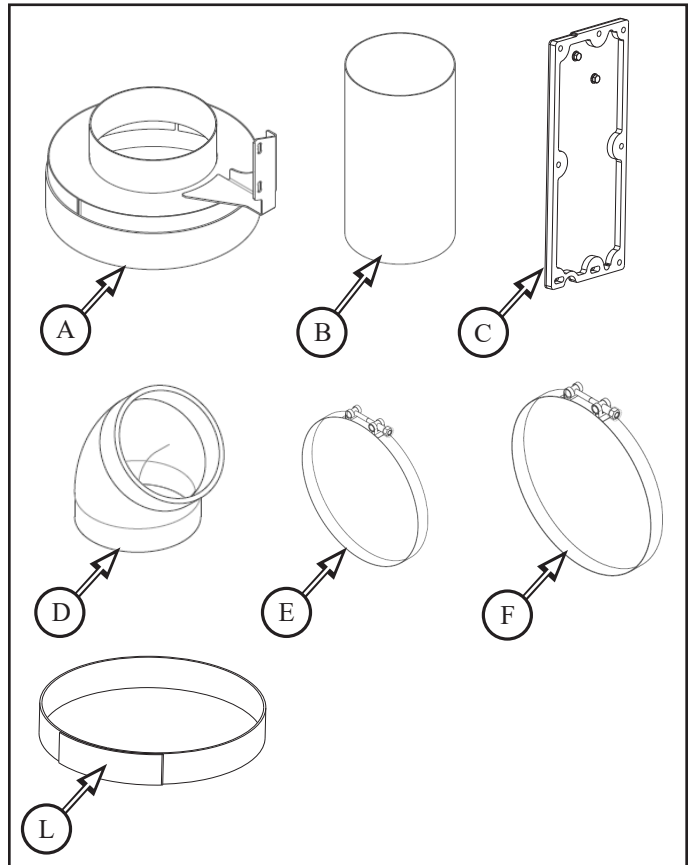

**** Ensure dust, dirt and chaff is blown away from work area ****

1.1 Ensure that the clamp (J1) that holds the strata tube (J) to the bottom elbow (J2) is tight - to prevent the silicone seal from breaking when removing the elbow (G)

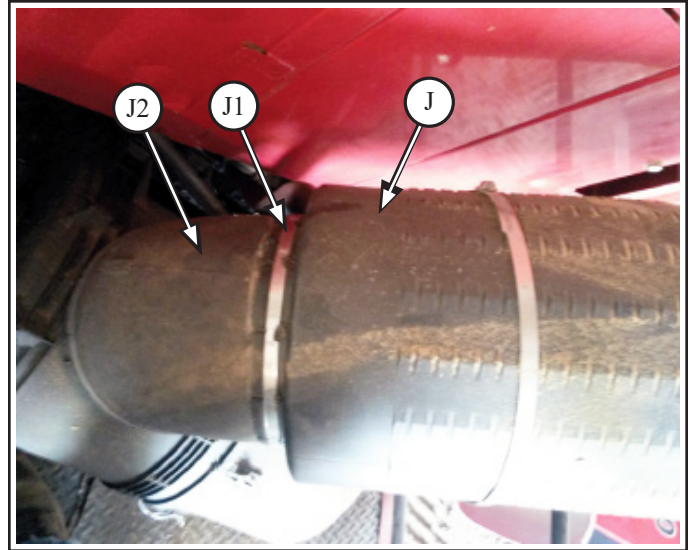



WARNING ** Ensure no debris enters engine intake while transition chute is removed **

- 1.2** Remove OEM intake elbow (G) from radiator box (H)
- hardware (G1) to be reused
- clamping rings (if equipped) not to be reused

- 1.3** Remove OEM intake elbow (G) from strata tube (J)
- hose clamp (K) not to be reused
- intake elbow (G) not to be reused

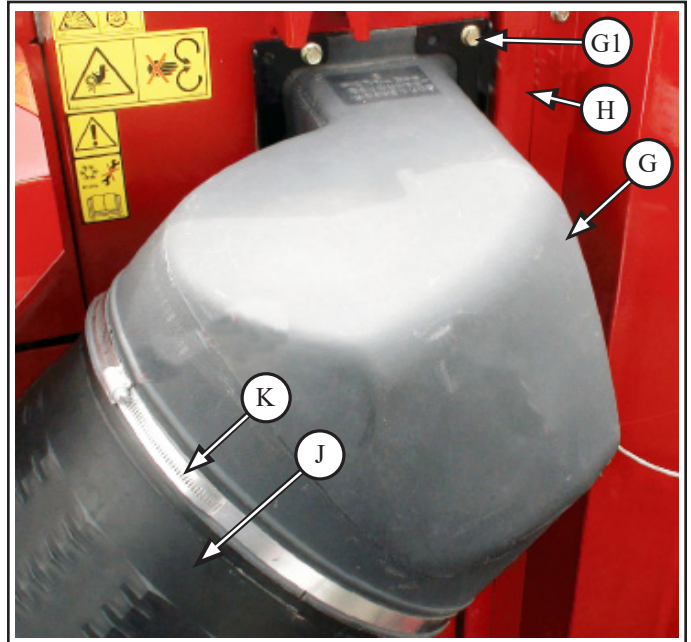

- 1.4** Inspect all strata tube openings (J) to ensure they are clean. If dirty, disassemble from filter housing and clean then reassemble

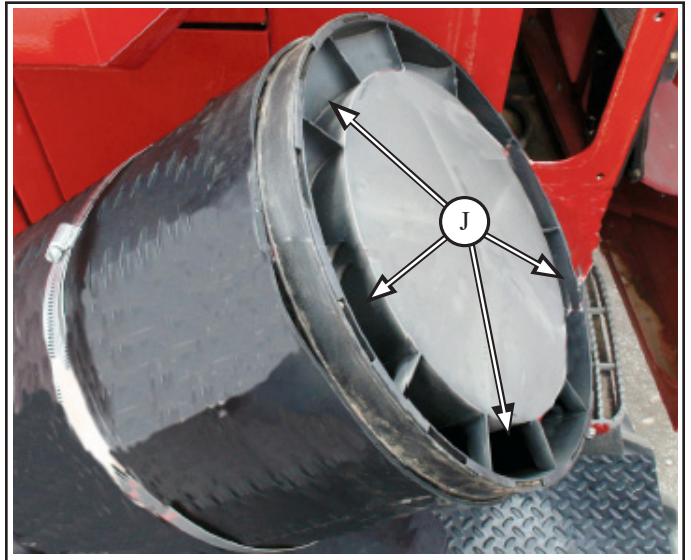

- 1.5** Slide rubber seal (L) over outside of strata tube (J)

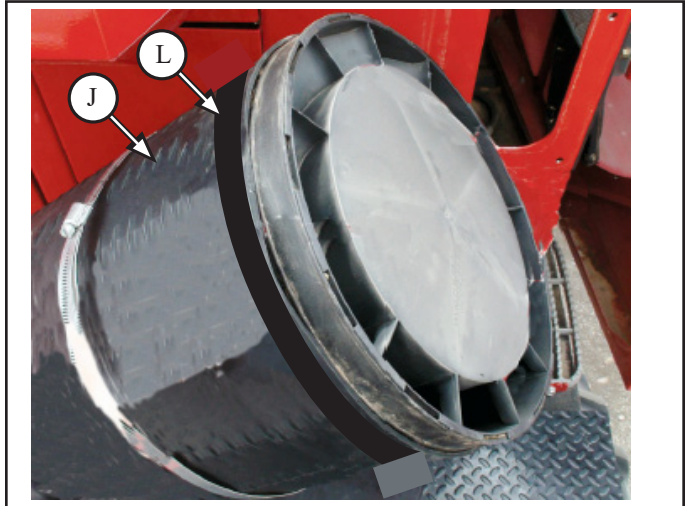

1.6 Install adaptor assembly (A) to strata tube (J) over rubber seal (L), with:

- slide rubber seal down to overlap edge of adaptor and strata tube, to ensure no air escapes thru seam
- hose clamp (F) x2 - one on rubber seal on strata tube and one on adaptor
- adaptor may have to be rotated to align for mounting

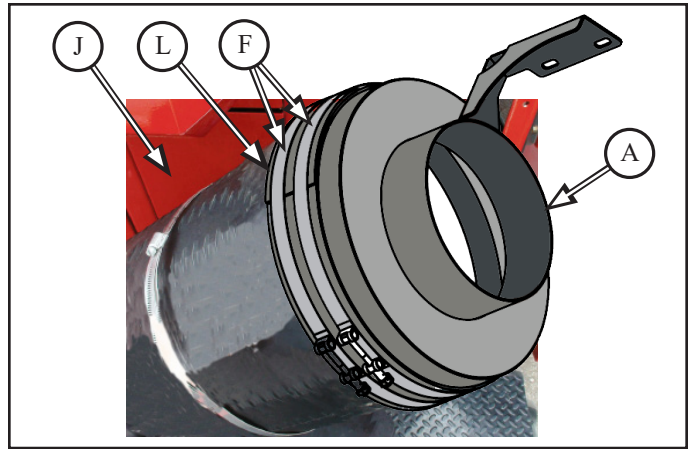

1.7 Install radiator/adaptor plate (C) over radiator hole (G1) after removing elbow (G), with:

- M8 x 35 flange head bolt and flange nut (C1) x4-6
 - qty and location of mount hardware may vary by combine
- ensure studs (C2) are on outside and at top

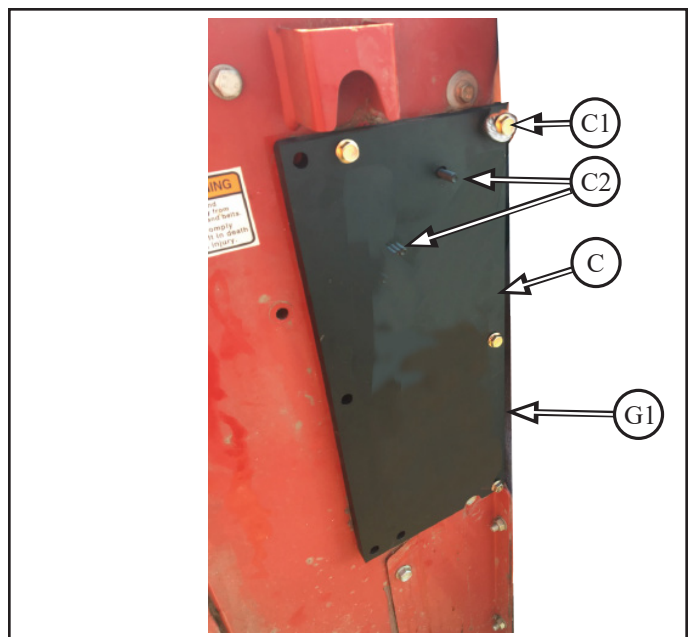

1.8 Install adaptor assembly bracket (A) to radiator/adaptor plate (C) studs (C2), with:

- M8 flange nut (A1)
- rotate adaptor in order for bracket to align with studs and then retighten hose clamps (F)

1.8.1 Torque to 9 N*m (80 in-lbs)

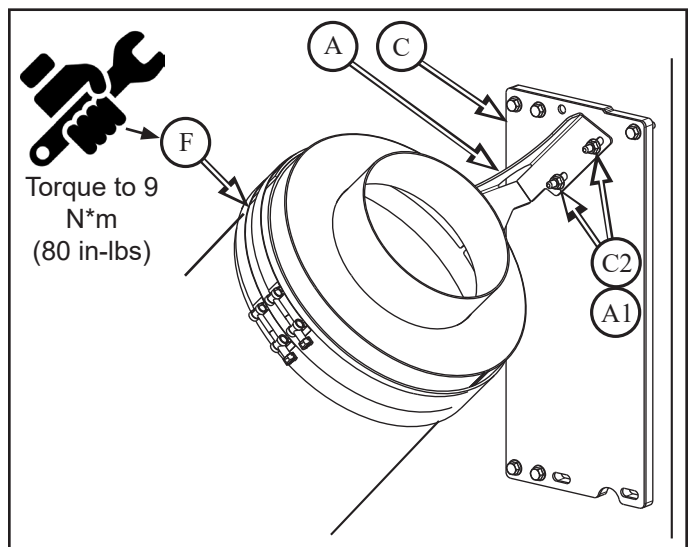

1.9 Install elbow (D) to adaptor assembly (A), with:
- hose clamp (E)

1.9.1 Torque to 9 N*m (80 in-lbs)

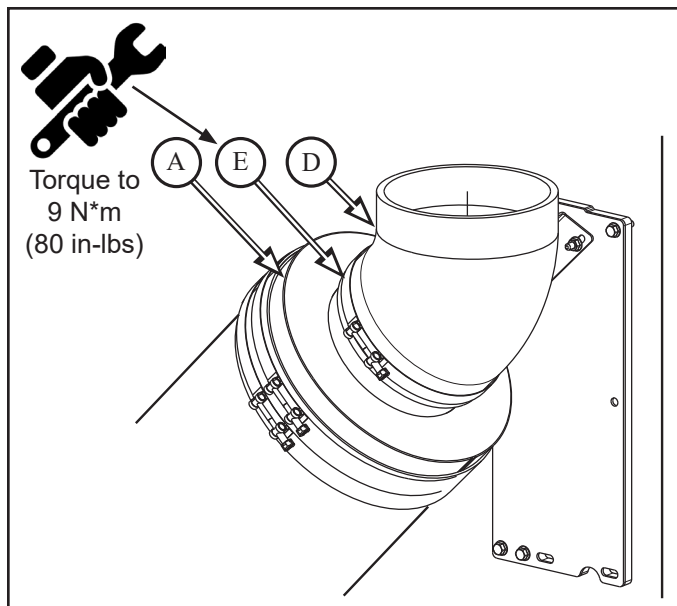

1.10 Install air intake tube (B) to elbow (D), with:
- hose clamp (E)

1.10.1 Torque to 9 N*m (80 in-lbs)

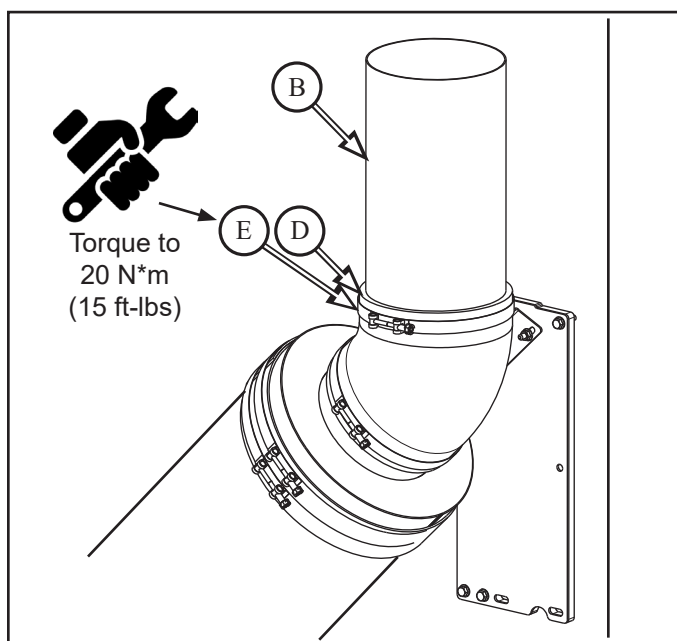

1.11 If equipped with the KAS Pre-cleaner, see section 2 of complete installation

2 KAS Pre-Cleaner Installation

Parts List:

KA800A	KAS Pre-cleaner assembly 8in (A)	Qty 1
RP1535	Clamp T-Bolt Band 0.25 x 8.5 ID SS (B)	Qty 1

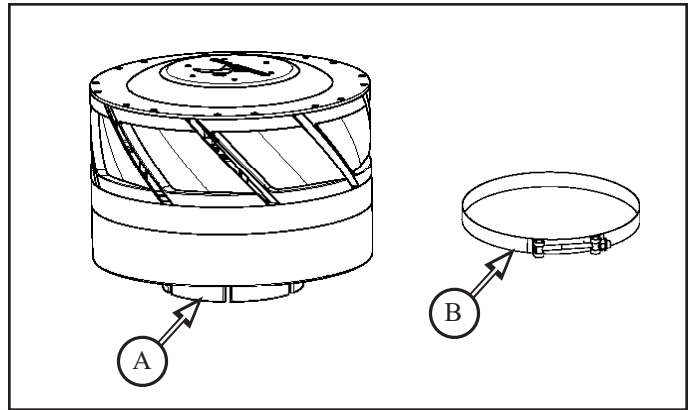

2.1 Install KAS Pre-cleaner assembly (A) on to intake tube (F), with:
- hose clamp (B)

2.1.1 Torque to 20 N*m (15 ft*lb)

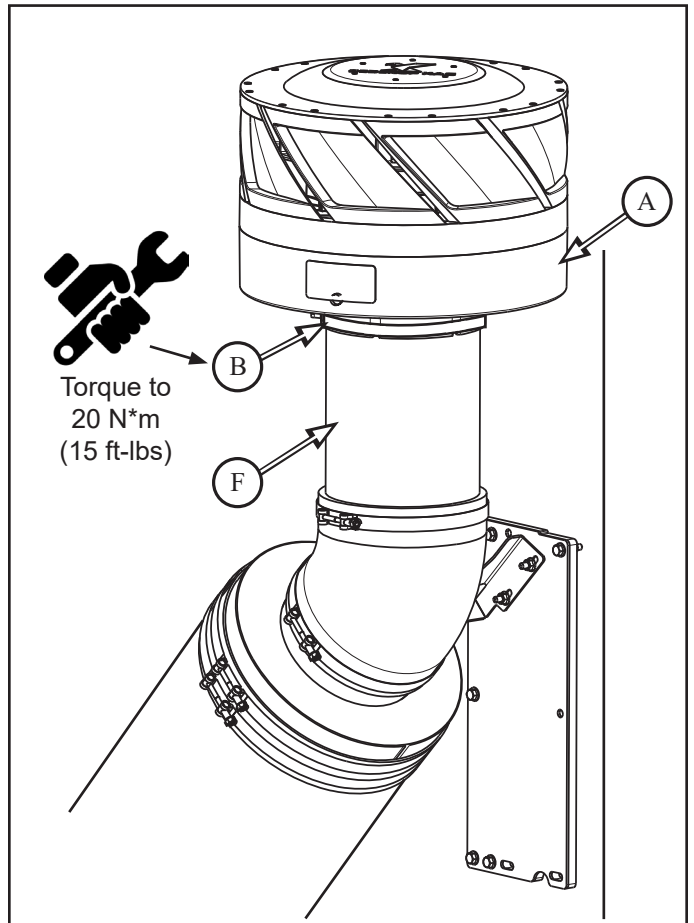



CAUTION: When the grain tank extensions and the auger are folded down, the KAS Pre-cleaner will be the tallest point on the combine

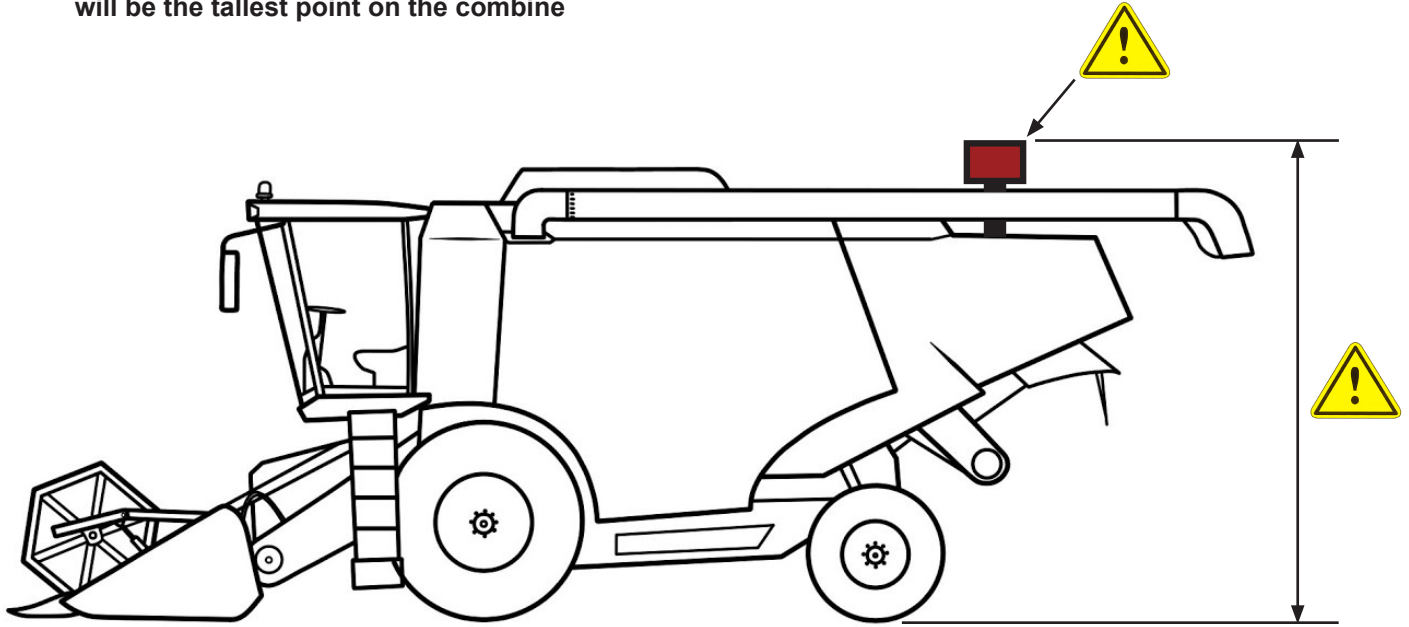

Torque Table		
Nominal Size	Class 8.8	Class 10.9
	Nm / (ft-lbs)	Nm / (ft-lbs)
M8 - flanged	27 / (20)	39 / (29)
- non flanged	25 / (18)	35 / (26)
M10 - flanged	54 / (40)	57 / (42)
- non flanged	49 / (36)	70 / (51)
M12 - flanged	93 / (69)	134 / (98)
- non flanged	85 / (63)	121 / (90)



Check all fasteners to ensure they have been properly tightened



Check that all tools and loose hardware have been removed from the machine before running

REDEKOP MANUFACTURING

1.866.REDEKOP (1.866.733.3567)

Saskatoon, Saskatchewan Canada S7K 3J7
info@redkopmfg.com
www.redkopmfg.com

For additional and the most up to date Manuals:



EQR002

REDEKOP™

REDEKOP™