

Straw Tine Deflector (SC731K)
for JD S-Series
Installation Manual

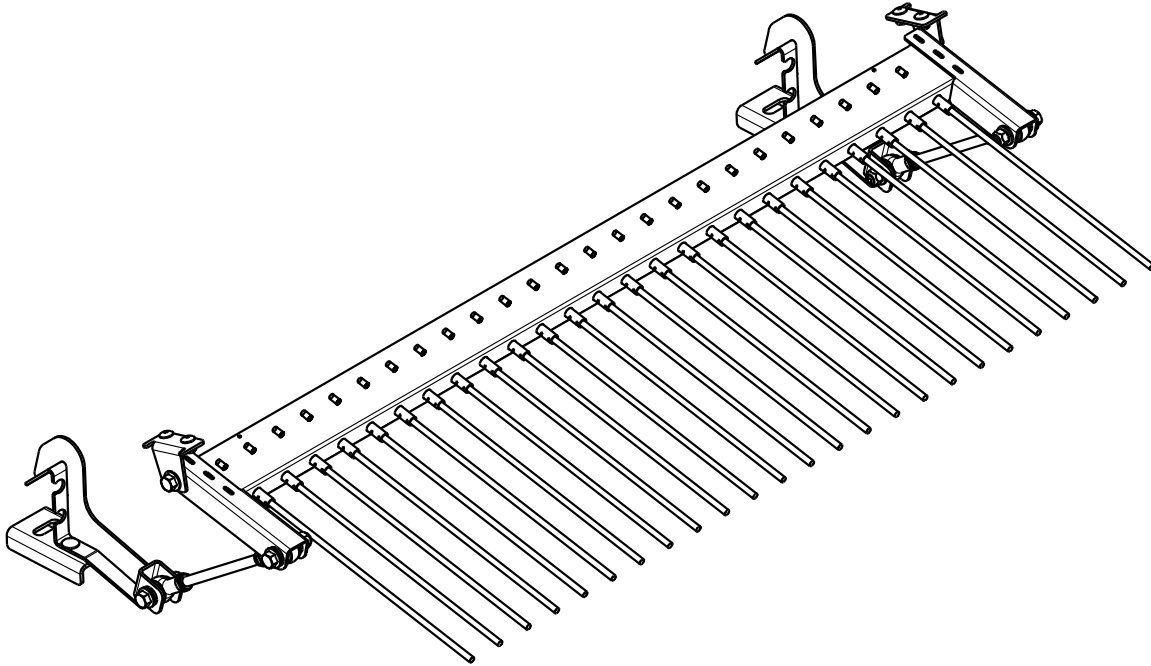

Straw Tine Deflector Installation

Parts List:

SC733GL	Shoe Mount Bracket (A)	Qty 2
SC734G	Bottom Shoe Mount Bracket (B)	Qty 2
SC732A	Link Tine Assy (D)	Qty 2
RP1368	Flanged Bushing (E)	Qty 10
SC731GA	Straw Tine Deflector Frame (F)	Qty 1
SC731-03A	Tine Rod Assy (P)	Qty 25

Mounting Brackets for No Overshot Beater:

SC735G	Upper Tine Mount Bracket (C)	Qty 2
--------	------------------------------	-------

Mounting Brackets for Overshot Beater:

SC790-01_Template	Drill Template (G)	Qty 1
SC790GL	Upper Mount Bracket Left (HL)	Qty 1
SC790GR	Upper Mount Bracket Right (HR)	Qty 1

Mounting Brackets for S600:

SC796G	Wedge Bracket (M)	Qty 2
SC801G	Spacer (N)	Qty 2

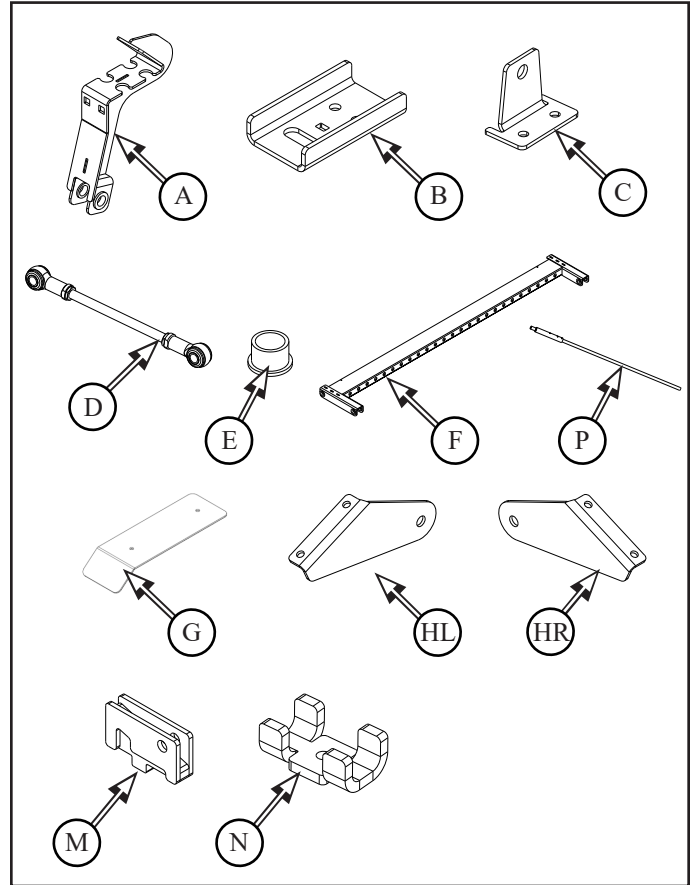

S700 Series Mounting Brackets:

1.1.1 Place shoe mount bracket (A) onto left and right corner of shoe platform (J)

1.1.2 Attach bottom shoe mount bracket (B) to shoe mount bracket (A), with:

- M10 x 25 round head bolt and lock nut (B1) x2
- both sides

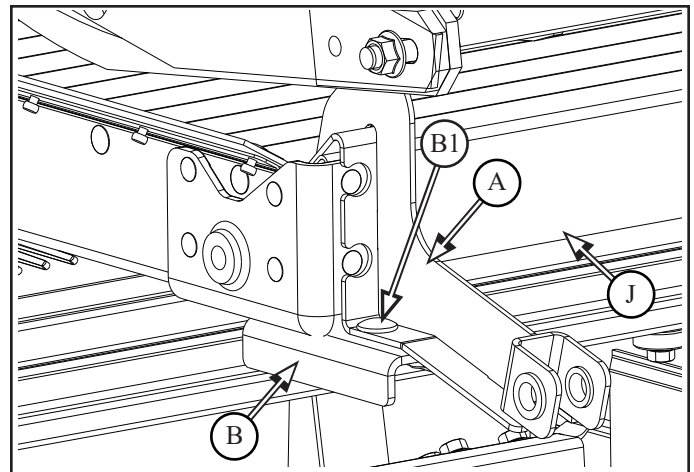

1.1.3 Overall view with shoe mount brackets (A) installed

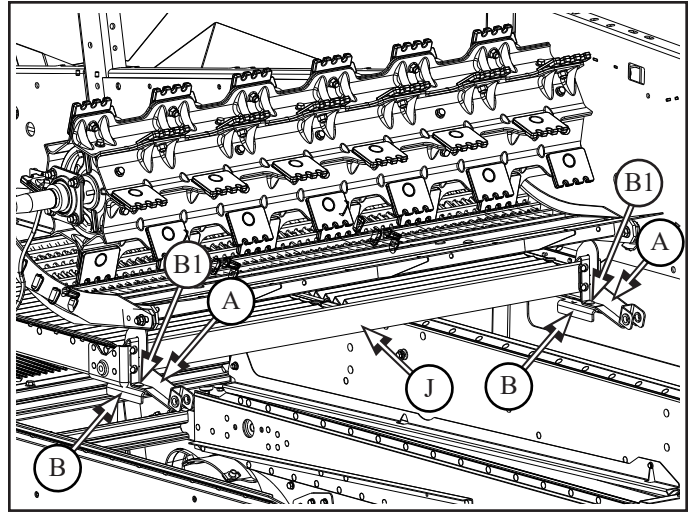

S600 Series Mounting Brackets:

1.2.1 Clamp wedge bracket (M) to bottom of left shoe corner platform (J), flush with inside edge

1.2.2 Drill 6.5mm hole (M1) thru hole in bracket (M) thru shoe platform (J)
- both sides

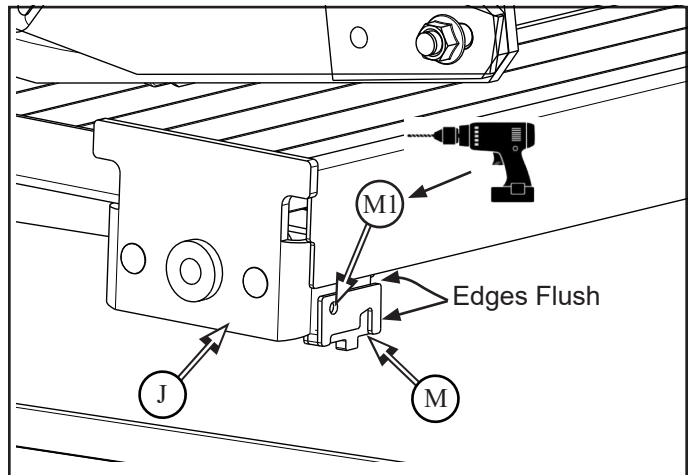

1.2.3 Install wedge bracket (M) to corner of shoe platform (J), with:

- M6 x 20 hex head bolt and lock nut (M1)
- both sides

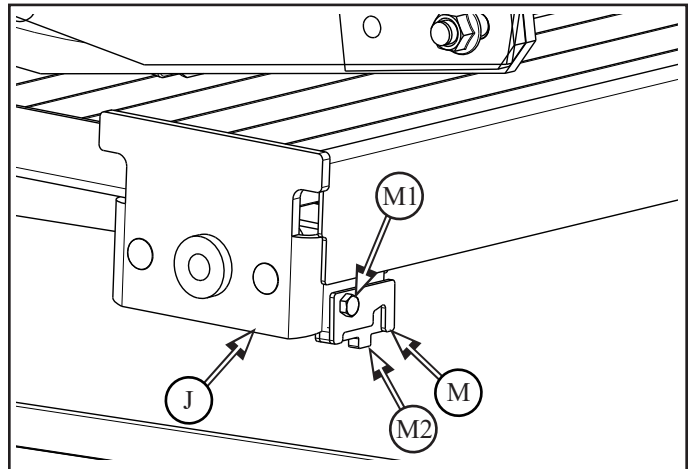

1.2.4 Place spacer (N) onto inside face of shoe mount bracket (A)

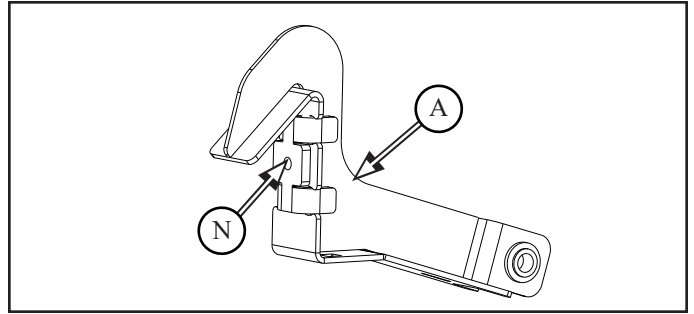

1.2.5 Place shoe mount bracket (A) onto left and right corner of shoe platform (J)

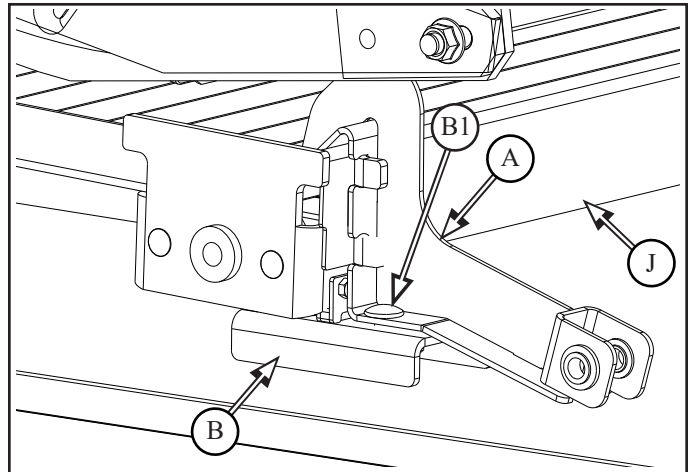

1.2.6 Attach bottom shoe mount bracket (B) to shoe mount bracket (A), with:
- ensure protrusion (M2) on wedge bracket (M) sits into hole in bottom shoe mount bracket (B)
- M10 x 25 round head bolt and lock nut (B1) x2
- both sides

1.2.7 Overall view with shoe mount brackets (A) installed

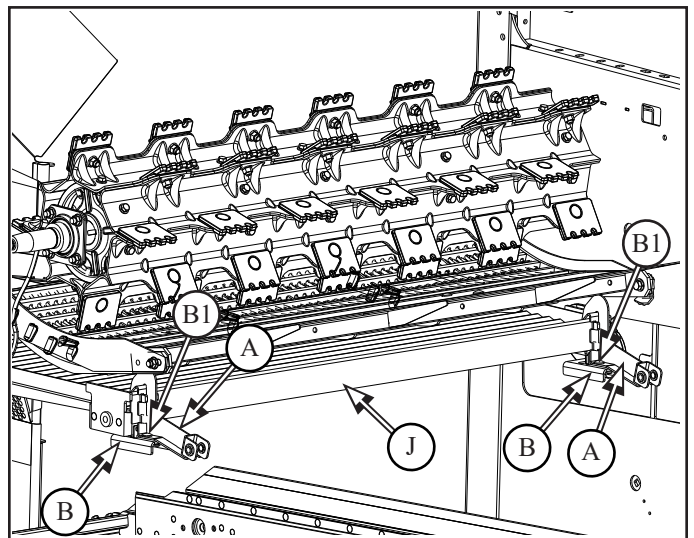

Without Overshot Beater:

2.1.1 Clamp upper tine mount bracket (C) to underside of beater floor extension (K) aligning to rear and side edge.
- both sides

2.1.2 Mark holes or using mount bracket (C) as a template, drill 9mm hole (C1) x2 thru beater floor extension (K)
- both sides

2.1.3 Install upper tine mount bracket (C) to underside of beater floor extension (K), with:
- M8 x 16 round head allen socket bolt and flange nut (C1) x2
- both sides

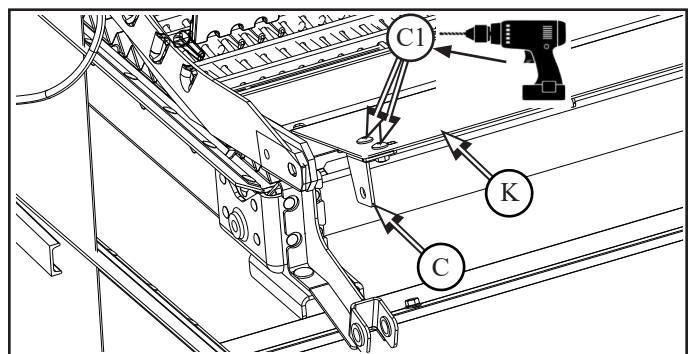

With Overshot Beater:

2.2.1 Clamp drill template (**G**) to overshot beater floor extension (**L**) aligning to side edge.

- both sides

2.2.2 Drill 8.5mm hole (**G1**) x2 thru overshot beater floor extension (**L**)

- both sides

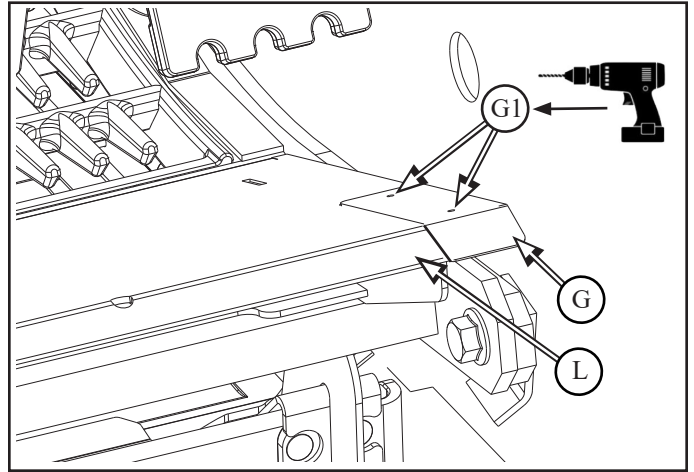

3 Install upper tine mount bracket (**HL**) to underside of overshot beater floor extension (**L**) thru holes (**G1**) just drilled, with:

- M8 x 16 round head allen socket bolt and flange nut (**H1**) x2
- repeat for otherside

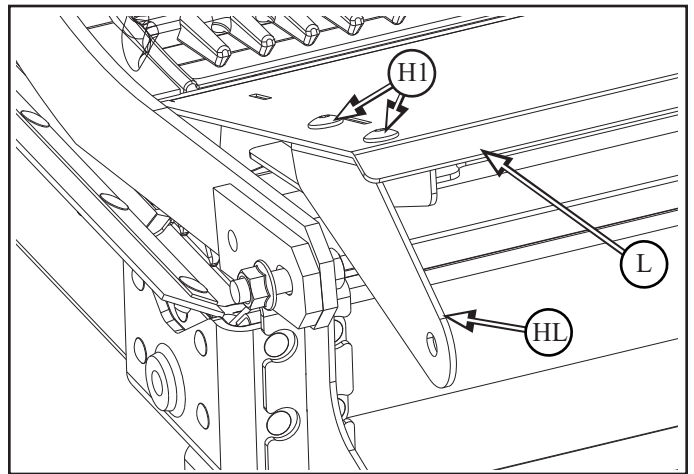

4 Install tine rod assembly (**P**) x25 to straw tine deflector frame (**F**), with:

- M8 nylon lock nut (**P1**) x25



Do Not use an Impact Wrench

4.1 Torque (**P1**) to 0.68 N*m (6 ft*lbs, 72 in*lbs)



Do Not overtighten - alum. threads will strip

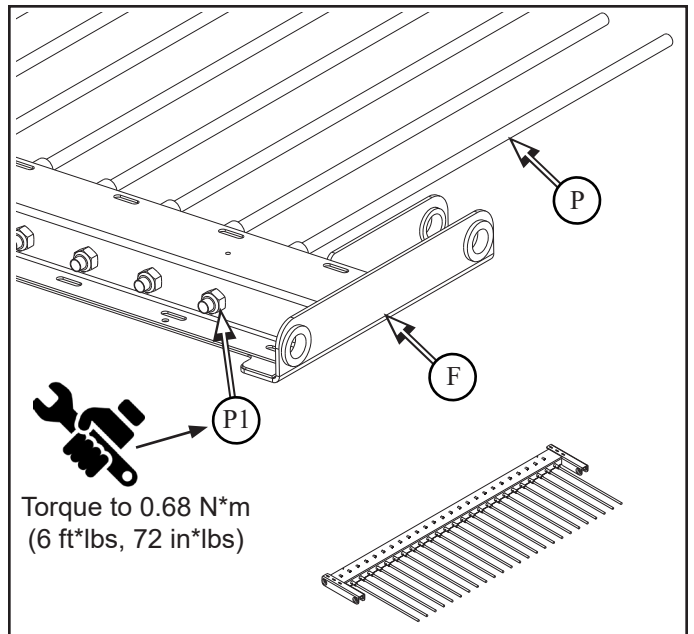

5 Install link assembly (D) into arms of straw tine deflector assembly (F), with:

- M12 x 60 hex bolt and lock nut (D1)
- flanged bushing (E) x2
- both sides

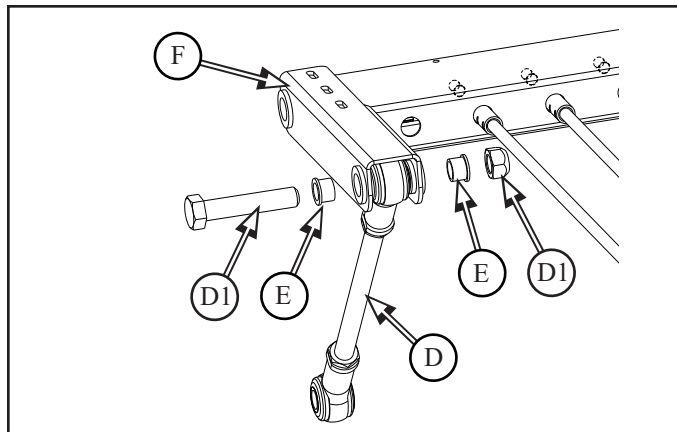

6 Install straw tine deflector assembly (F) to upper tine mount bracket (C) (or H with overshoot beater) with:

- M12 x 30 flange bolt and lock nut (F1)
- flanged bushing (E) on nut side
- both sides

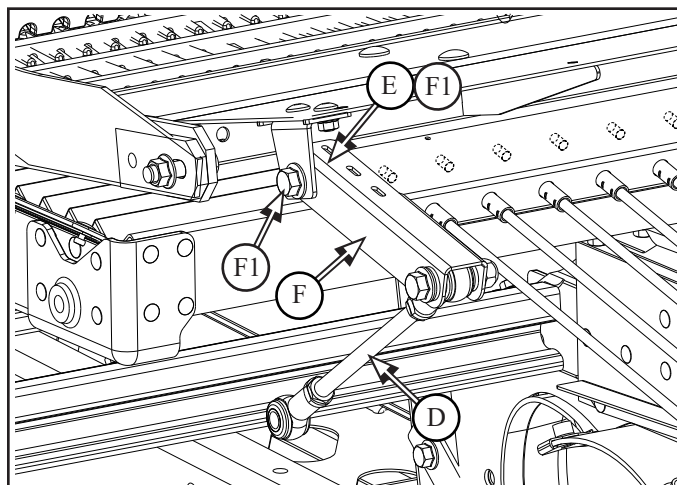

7 Install link assembly (D) into shoe mount bracket (A), with:

- M12 x 60 hex bolt and lock nut (D2)
- flanged bushing (E) x2
- both sides

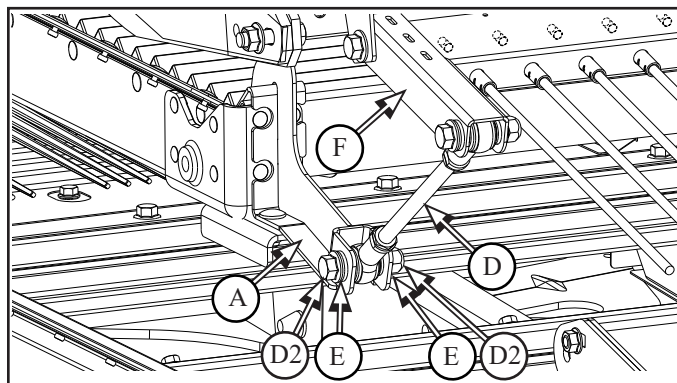

8 Turn threshing system so that the return pan (R) is fully forward

8.1 Set position of tine assembly so that end of tines (P) are positioned at middle of nose of panel (S)

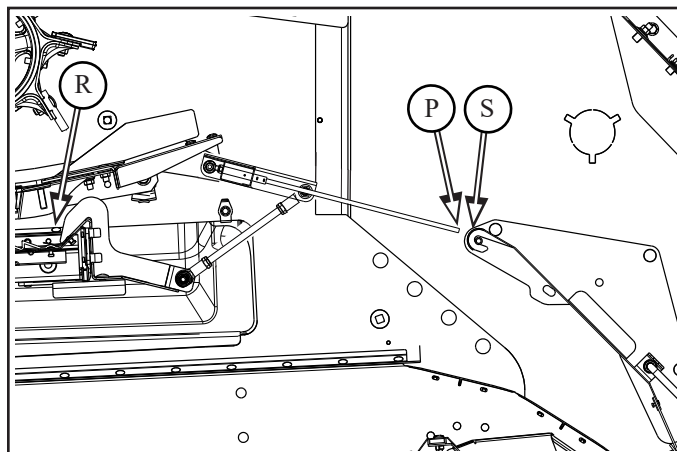

9 View with straw tine deflector assembly (F) installed

